

Double-Flange Air Heaters: The Recycling Specialists.

As a result of their two flanges and the compact construction, double-flange air heaters are suitable for integration in air duct systems. The supply air temperature can be extremely high at 320°F so preheated air can be reused and valuable energy saved.

Air Heater

LE 5000 DF



Technical Data LE 5000 Double Flange

Easy to integrate in existing air systems		•
Suitable for recycling air		•
Simple and safe fixture options		•
No integrated power electronics		•
Max. air outlet temperature °F		1292
Max. air inlet temperature °F		320
Min. air flow scfm	4.5 kW	15.9
	7.5 kW	30.0
Max. ambient temperature °F		212
Weight lb		4.19
Mark of conformity		CE
Protection classe I		⊕

Optional Power Controller

DSE three-phase controller (Page 23)

Optional Temperature Regulation

DSE three-phase controller and KSR DIGITAL temperature regulator (Page 22 / 23)

Installation Dimensions in inch

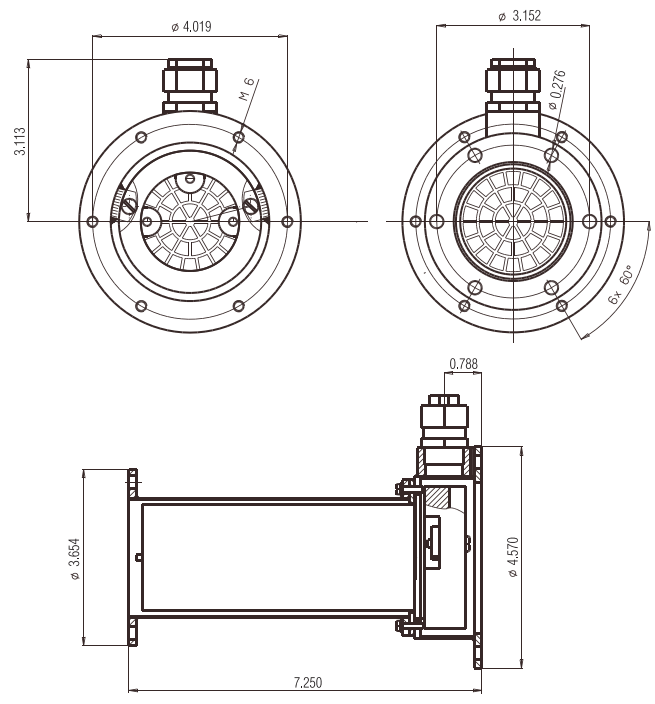

Voltage V ~		3 × 400	3 × 400
Power consumption kW		4.5	7.5
LE 5000 DF	Order no.	117.551	114.240

Additional versions on request

Air Heater

LE 10 000 DF



Technical Data LE 10000 double flange		LE 10000 DF	LE 10000 DF HT
Easy to integrate in existing air systems		•	•
Suitable for recycling air		•	•
Simple and safe fixture options		•	•
No integrated power electronics		•	•
Max. air outlet temperature °F		1202	1652
Max. air inlet temperature °F		320	320
Min. air flow scfm.	5.5 kW	17.6	
	11 kW	38.8	
	17 kW	61.7	
	15 kW HT		29.3
Max. ambient temperature °F		212	212
Weight lb		7.5	8.8
Mark of conformity		CE	CE
Protection classe I		⊕	⊕

Optional Power Controller

DSE three-phase controller (Page 23)

Optional Temperature Regulation

DSE three-phase controller and KSR DIGITAL temperature regulator (Page 22 / 23)

Voltage V ~	3 × 400	3 × 400	3 × 400	3 × 400
Power consumption kW	5.5	11	17	15
LE 10000 DF Order no.	115.571	114.555	116.135	
LE 10000 DF HT Order no.				116.056

Additional versions on request

Installation Dimensions in inch

