

LE 10000 S

The air heater LE 10000 S is equipped with a performance range of 10 kW at 3 x 230 V, of 11 kW and 17 kW at 3 x 400 V, as well as 16 kW at 3 x 480 V. The air supply and air outlet connections are compatible with the successor LHS 60L and its accessories. The LE 10000 S is also available as a version for a supply temperature of up to 160°C, and is therefore especially suitable for recycling applications.

Air heater

LE 10000 S



Combination possibilities

Leister air heater with Leister blower at maximum heat power. Hot-air temperature 3 mm after air outlet, measured at the hottest point, at hose length 3 m and unimpeded air outflow. Air flow in l/min when air heater is not heated and air inlet temp. is 20 °C.

Power Type	Number LE × Power consumption W	Air flow l/min	Temperature °C
SILENCE	1 × 9500	1 × 2000	400
SILENCE	2 × 10000	2 × 1500	460
ASO	2 × 9500	2 × 2450	320
ASO	4 × 10000	4 × 2100	350
AIRPACK	2 × 10000	2 × 1600	440

Air flow and temperature specifications may deviate from ideal values due to modifications of the hot-air system (nozzles, hose length, etc.).

Technical data LE 10000 S

	Without Electronic	With Electronic	For KSR DIGITAL
Heating power steplessly adjustable with potentiometer		•	
Thermoswitch for device protection		•	•
Integrated heating element protection		•	•
Remote control interface for KSR DIGITAL temperature regulator or external PLC control 0 – 12 V incl. 5 m cable and plug			•
Max. air outlet temperature °C,	650	650	650
Min. air flow l/min. 10 and 11 kW	1700	1000	1000
16 and 17 kW	2200	1750	1750
Max. air inlet temperature °C	100	50	50
Max. ambient temperature °C	100	60	60
Weight kg	3.4	3.4	3.4
Mark of conformity	CE	CE	CE
Approval mark		Ⓢ	
Protection classe I	Ⓢ	Ⓢ	Ⓢ

Voltage	V –	3 × 230	3 × 400	3 × 400	3 × 480
Power consumption kW		10	11	17	16
Without Electronic	Order no.	102.753	102.768	102.770	102.779
with Electronic	Order no.	102.747	102.760	102.765	102.777
for KSR DIGITAL	Order no.		110.968		112.372
Without Electronic					
Supply air					
max. temp. 160 °C	Order no.			113.967	

Additional versions on request

Einbaumasse in mm

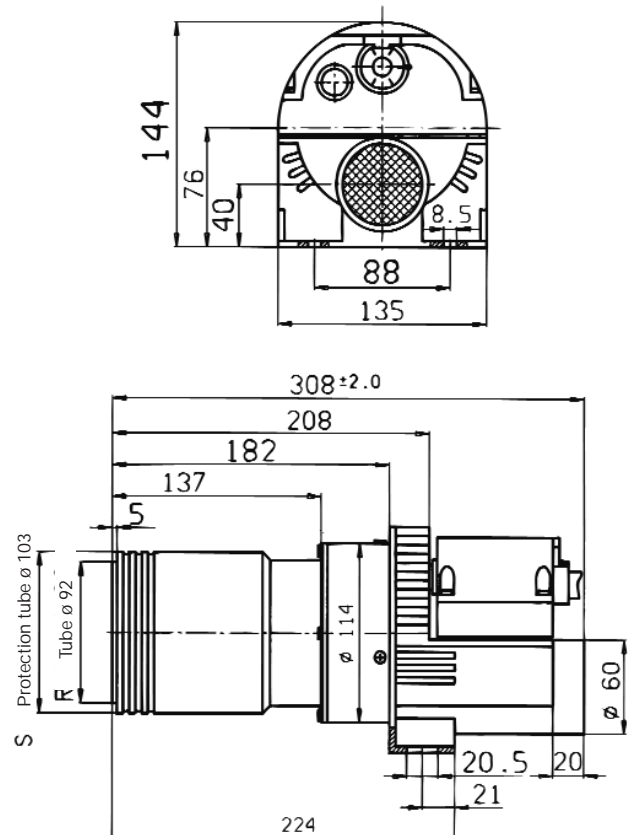

Accessories LHS Type 60L / VULCAN E / LE 10000 HT (Ø 3.62 inch)

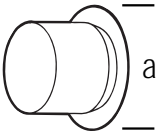
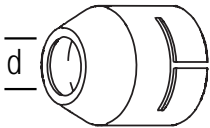
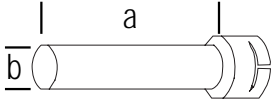
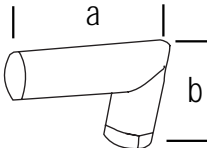
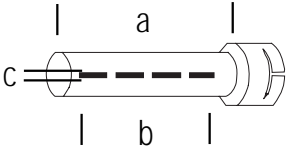
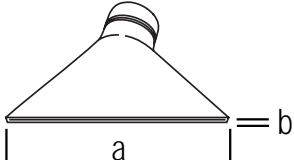
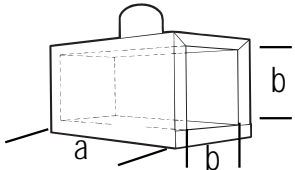
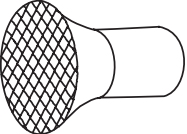
125.318		Flange connector, push-fit a = 4.72 inch
107.244		Round nozzle, push-fit d = 1.97 inch
107.273		Extension nozzle, push-fit (a × b) 19.7 × 2.36 inch
107.269		Angled nozzle, push-fit (a × b) Schenkellänge 6.89 × 6.89 inch
106.031 106.035 107.268 106.036 106.033 106.038		Tubular nozzle, push-fit (a × b × c) 39.4 × 31.5 × 0.08 inch 46.7 × 35.4 × 0.06 inch 50.7 × 39.4 × 0.06 inch 60.4 × 49.2 × 0.05 inch 61.0 × 53.1 × 0.04 inch 87.6 × 78.7 × 0.03 inch
107.274 106.028 107.272 106.018 106.024 107.267 106.023 106.026		Wide slot nozzle, push-fit (a × b) 5.12 × 0.67 inch 8.66 × 0.47 inch 11.8 × 0.47 inch 15.7 × 0.39 inch 19.7 × 0.28 inch 19.7 × 0.59 inch 23.6 × 0.16 inch 23.6 × 0.35 inch
107.341		Shell reflector, push-fit (a × b) 14.6 × 6.30 inch
107.276		Sieve reflector, push-fit Ø 10.2 inch